

The logo for 'energreen' is displayed in white lowercase letters within a green, leaf-like shape. The background of the entire page is a blurred image of a person's hands holding a smartphone.

energreen

CONNECTION WIFI

Onduleur GOODWEE

Energreen S.A.

Avenue Franklin 5C
1300 Wavre
Belgique

Tél: +32 (0) 10 45 13 73
Email: wavre@energreen.be

Section 2. Wi-Fi Configuration

Step 1. Click "Wi-Fi Configuration" at login page or click Wi-Fi icon at homepage.

Step 2. Make sure inverter is power on and then click "Next".

Step 3. Click "Go into WLAN setting interface".

Step 4. Connect smart device to SolarWiFi* and then return to Wi-Fi configuration page of SEMS Portal.

Step 1

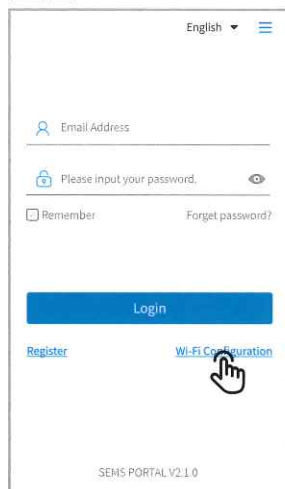

Step 1

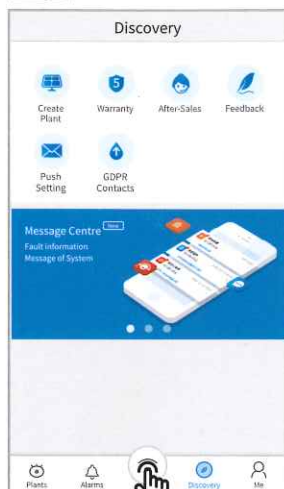

Step 2



Step 3



Step 4



Step 5



Step 5. Click "Next".

Step 6. Enter Wi-Fi network name and password accordingly and then click "Set". Please switch off DHCP first and input IP address if you want to change inverter's IP into a specific one.

Step 7. Confirm and then click "OK".

ⓘ It is strongly recommended that you change the password of your "Solar-WiFi*" before or after the installation. The manufacturer will NOT be responsible for any of the privacy information leakage caused by using the default password of "Solar-WiFi*". For how to change the password of "Solar-WiFi*", please refer to "Section 3. More Information" of "Option 1. Web Configuration".

Step 6

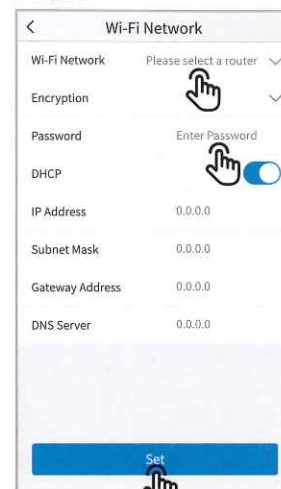

Step 6

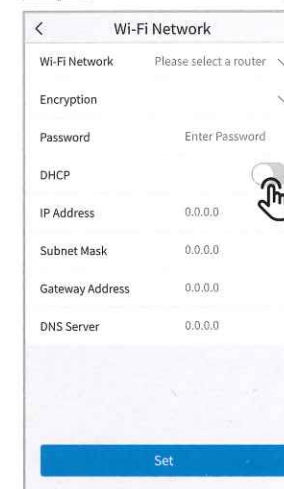

Step 7

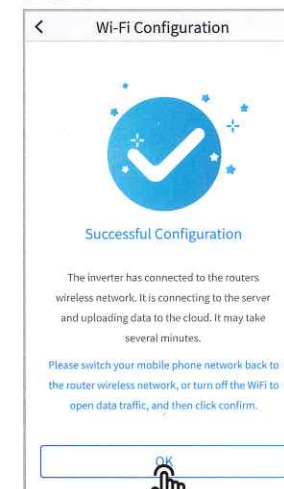

ⓘ You may click "Reconfigure" or follow instruction of "Configuration Help" if configuration failed.

